



SPECIFICATION

MODEL
K-EC146-G230-32

I、 Nominal data		
Phase	~	1
Nominal voltage	VAC	230
Frequency	Hz	50/60
Speed	RPM	3200
Max. Power input	W	220
Max. Current draw	A	1.6
Noise	dba	74
Certification	~	~
Min. ambient temperature	°C	-25
Max. ambient temperature	°C	60

II、 Technical features	
Size (L*W*H)	229.5*277.3*229mm
Material of impeller	Plastic
Direction of Impeller rotation	Clockwise (viewed from rotor)
Rotor surface treatment	Spray
IP rating	IP55
Insulation class	B
Operation mode	S1
Bearing-motor	Ball bearing
Motor protection	Locked rotor, thermal protection, high and low voltage protection
Lead length	500mm±20mm
RoHS	All parts are RoHS compliant.
Working humidity	5%-90%RH
Motor Type	Outer rotor EC motors
Axial runout of impeller	≤0.5mm
Impeller radial runout	≤0.5mm

III、Chart

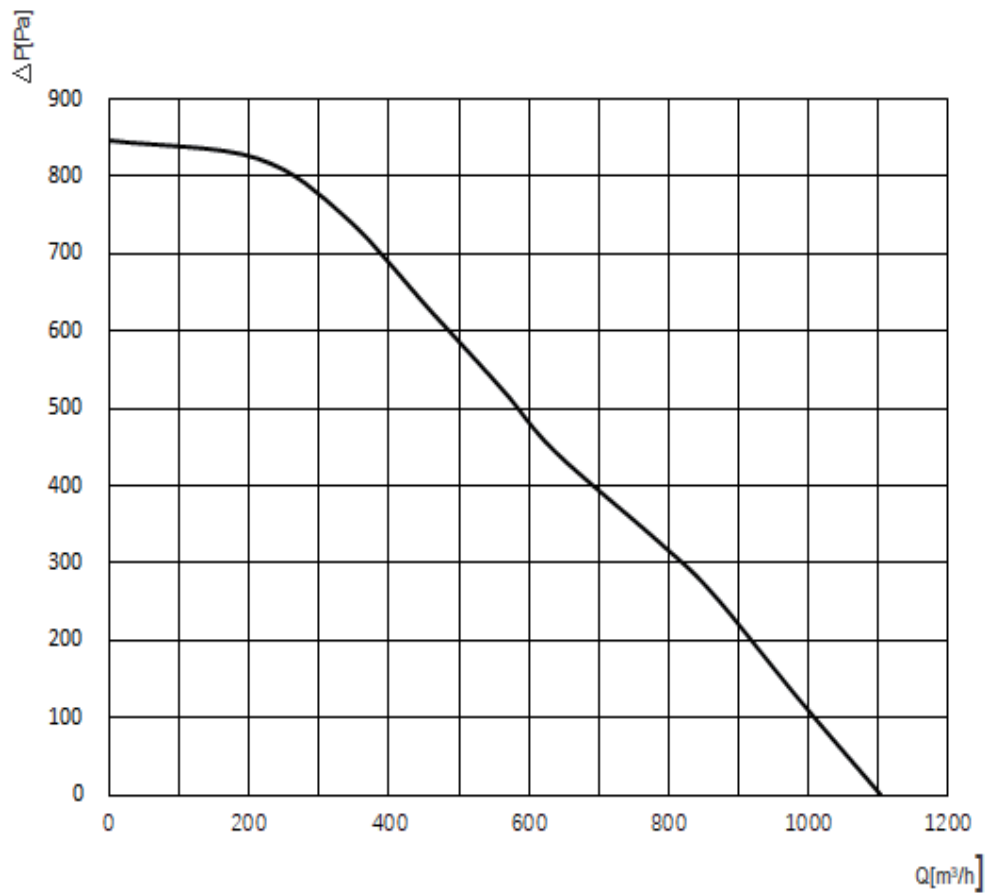

IV、Product drawing

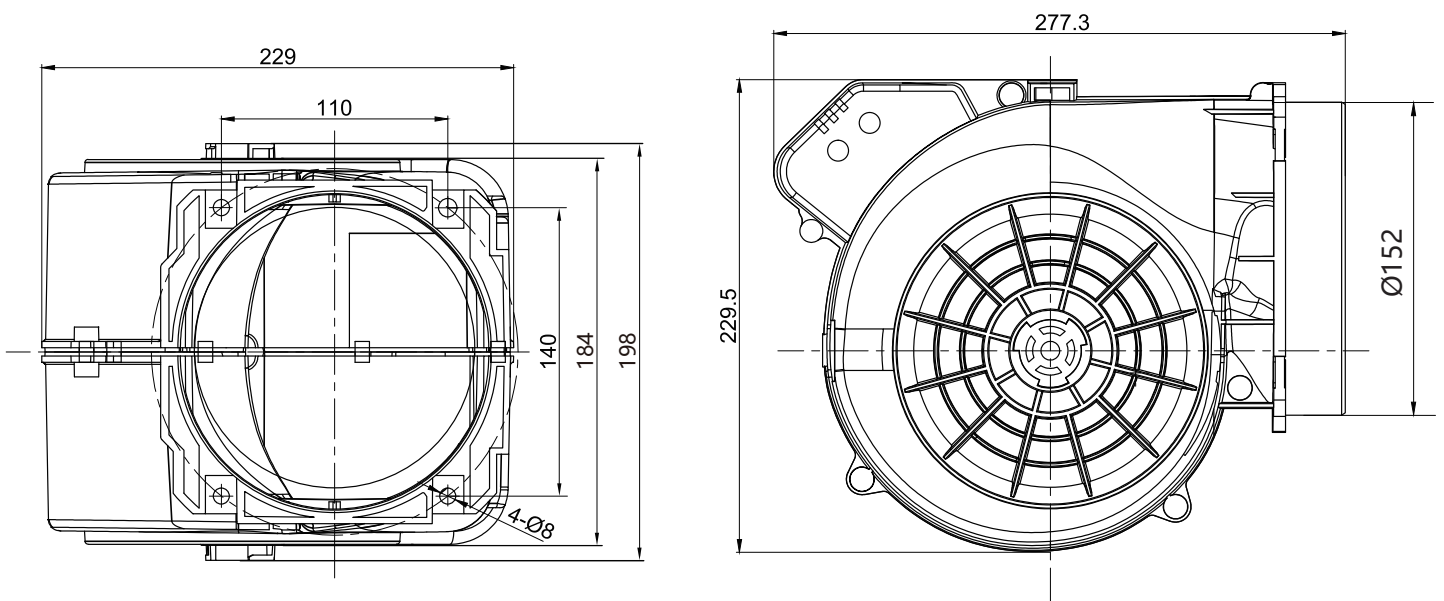

V、 Connection screen				
Lead	Connection		Color	Function
Power cord	P		Yellow Green	Earth Wire
	U1	L	Brown	Live Wire
	U2	N	Blue	Neutral Wire
Control wire	U4	+10V	Red	External output voltage +10V
	U5	0-10V speed regulation	Yellow	0-10V/PWM speed regulation
	U6	FG	White	Speed output 2 pulses/revolution
	U7	GND	Blue	Control wire earth

Power cord

Control wire

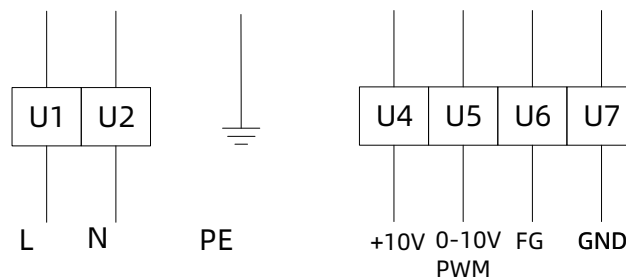

VI、 Others

1. Please connect the power line and control line of the fan in strict accordance with the wiring diagram to prevent the fan from burning out;
2. Do not connect the white signal wire directly to the red signal wire or external DC power supply;
3. If the fan does not work after starting, please check the input voltage of the speed regulation, it may be badly connected. Prevent hand or other personal injury caused by the sudden start of the fan; do not touch the impeller or rotor after power-on;
4. It takes a few seconds for the fan to start after powering on. To prevent personal injury, do not touch the impeller or rotor when power is on or at low speed;
5. This fan should not be used by persons lacking physical, mental or sensory ability and appropriate practical experience or expertise unless directed by those responsible for their safety. Do not allow children to touch this product.
6. If the power cord is damaged, the power cord must be replaced by the manufacturer;
7. As an integral part of the fan, the motor cannot be used alone without an impeller or load;
8. After the product packaging is disassembled, if it needs to continue to be stored, it should be repackaged. The product should be stored in a clean and well-ventilated warehouse with an ambient temperature of $-10^{\circ}\text{C}\sim+40^{\circ}\text{C}$, a relative humidity of not more than 75%, and no corrosive gas in the air, and should be more than 15cm off the ground.
9. Please read this technical specification carefully before use.